

University of Idaho
 State of Idaho Division of Public Works
 Castellaw Kom Architects

ADDENDUM NUMBER TWO

October 10, 2024

To all contract bidders of record for the work titled:

University of Idaho

DPW #23255
New Elevator / Access Improvements
BLD 065 Hartung Theater
 University of Idaho
 Moscow, Idaho

Architect's Project Number: 22082

Please notify everyone concerned (subcontractors and suppliers) as to the issuance and contents of this Addendum prior to the date of bid opening. **Contractor must acknowledge the addendum on their Bid Form.** This Addendum is a part of the contract documents and modifies them as follows:

GENERAL

- I. **Plan Holders List:** A copy of the current plan holders list is included in this addendum.
- II. **Utility Locates:** UI has had locates painted on site showing both Power and Sewer. Photos are attached for reference. Contractors are encouraged to visit the site and review the locates in person prior to bid.
- III. **Substitutions:** Several substitution requests have been received and reviewed as indicated below. This is an acceptance of general quality only. No attempt has been made to check each material as to special features, capacities, or physical dimensions specially required for the project. It shall be the responsibility of the supplier, manufacturer, and contractor to check all requirements before submitting for final acceptance. Final acceptance of exact features, sizes capacities, etc., all of which must match materials indicated and specified, will be determined when submitted during the construction period. Certain acceptances are subject to conditions noted.

Section	Item	Manufacturer
26 00 00	Lighting	Ambient Lighting and Controls
26 00 00	Lighting	JC Wright Lighting (Acuity)
07 41 00	EM1-1653 Wall Panel	Metal Sales

SPECIFICATION

- I. **Section 10 26 00 – Corner Guards**
 - A. **Revise** 3.2A to read as follows: *“Stainless steel corner guards to be provided at locations shown on plan.”*
- II. **Section 10 19 10 – Privacy Curtains**
 - A. **Add** the attached section in its entirety.

University of Idaho
 State of Idaho Division of Public Works
 Castellaw Kom Architects

ELECTRICAL

I. **Sheet E3.1**

- A. **REVISE** Keynote 4 to read as follows: *“LUMINAIRES SHALL BE CONTINUOUSLY ENERGIZED AND NOT TURN OFF. OCCUPANCY SENSORS SHALL BE PROGRAMMED TO DIM luminaires TO 30% OUTPUT WHEN NO MOTION HAS BEEN DETECTED FOR 20 MINUTES. ONCE MOTION IS DETECTED, LUMINAIRES SHALL ENERGIZE TO 100% OUTPUT AGAIN.”*

STRUCTURAL

I. **Sheet S2.1**

- A. **REVISE** Partial Basement Foundation Plan as follows:

- Show concrete foundation wall at SW corner of hoistway fully extending to enclose new addition.
- Extend foundation wall and footing to frost depth at NE corner of hoistway to intersect with exiting building (see highlighted areas below).

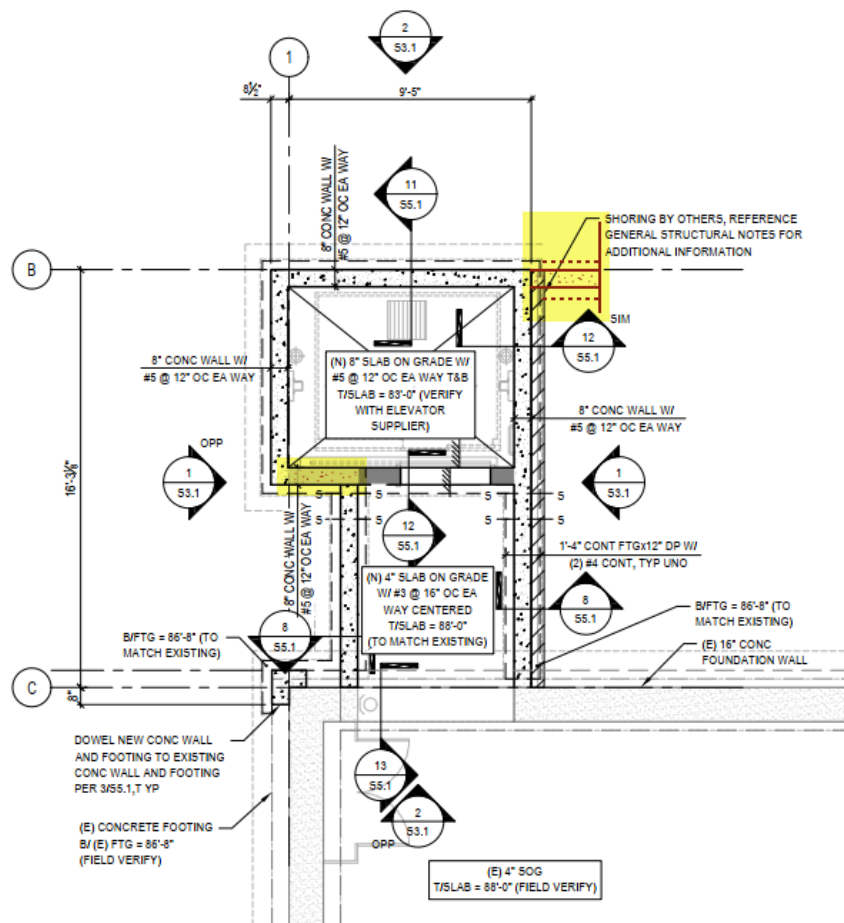

PARTIAL BASEMENT FOUNDATION PLAN

SCALE: 1/4" = 1'-0"

NORTH



REGISTER OF BID DOCUMENTS

PROJECT: 23255 UI: New Elevator / Access Improvements, Hartung Theater

CKA PROJECT NO: 22082

OWNER: State of Idaho Division of Public Works

REFUNDABLE DEPOSIT: \$200/EACH SET

INVITED LIST X_OPEN PREQUALIFICATION

TODAY'S DATE: October 10, 2024

BIDS DUE DATE: **Tuesday, October 15th, 2024 @ 2:00 PM (local) @ DPW Field Office – 875 Perimeter Drive, MS 2281Moscow, ID 83844**

PRE-BID MEETING: **Tuesday, October 1st, 2024 @ 9:00 AM (local) @ AES Facilities – 875 Perimeter Drive, MS 2281Moscow, ID 83844**

ADDM	NAME	ADDRESS	CITY	ATTN:	PHONE/FAX	EMAIL	SET #	NOTES
	Castellaw Kom Architects	1126 Main Street	Lewiston ID 83501	Bonnie Whismore	208-746-0183	office@ckarchitects.com		Architect
	Castellaw Kom Architects	1126 Main Street	Lewiston ID 83501	Brent Beaudoin	208-746-0183	bbeaudoin@ckarchitects.com		PM
	Coffman Engineering	221 N. Wall Street	Spokane, WA 99201	David Peden	509-328-2994	dave.peden@coffman.com		Struc
	Coffman Engineering	221 N. Wall Street	Spokane, WA 99201	Traci Hanegan	509-328-2994	hanegan@coffman.com		Mech
	Coffman Engineering	221 N. Wall Street	Spokane, WA 99201	Zachary Yarbrough	509-328-2994	zachary.Yarbrough@coffman.com		Elec
	Division of Public Works	875 Perimeter Drive, MS 2281	Moscow, ID 83844	Ken Cook	(208) 669-1045	ken.cook@adm.idaho.gov	1/2 Size	Owner
	Division of Public Works	502 N 4th Street, PO Box 83720	Boise, ID 83720-0072	Nicole Cecil	(208) 332-1905	Nicole.Cecil@adm.idaho.gov		Owner
	Division of Public Works	502 N 4th Street, PO Box 83720	Boise, ID 83720-0072	Zach Nadeau	208-332-1918	zach.nadeau@adm.idaho.gov		Owner
	University of Idaho	875 Perimeter Drive	Moscow, ID 83844	Daryle Faircloth	208-885-7346	darylef@uidaho.edu		Agency
	University of Idaho	875 Perimeter Drive	Moscow, ID 83844	Matt Proctor	208-885-8888	mproctor@uidaho.edu		Agency
	4 J Electric	420 28TH Street North	Lewiston ID 83501	Doug Engel	208-746-5573/F-746-2629	doug@4jelectric.com		
	C&C Construction of the Pacific NW	3925 Birdseye Rd	Helena, MT 59602	Jenn Hatfield	406-389-2253	northwest@roofing32425.com	PDF	
	K&G Construction (Plumbing)	625 D Street	Lewiston ID 83501	Lucas Martin	208-791-7427	lmartin@kandgconstructionllc.com		
	Mangum Construction	1451 Bridge St.	Clarkston WA 99403	Marshall Mangum	(509) 254-1514	marshall@mangum-construction.com		G.C.
	Advanced Coating	PO Box 5	Lewiston ID 83501	Allen Olander	208-791-0483/F-509751-8847	allen.olander@advanced-contracting.com		
	MBCI			Greg Chapman	800-735-6224	gchapman@cornerstone-bb.com		
	Gropp Heating & electric	PO box 8928	Moscow ID 83843	J Hansen	208-882-7672/F-882-3414	jhansen@moscow.com		
	Quality Contractors	307 Main/PO 164	Deary ID 83823	James McElroy	208-877-1840	james@quality-contractors.com		G.C.
	Mike's Heating & A/C (PLUMB)	1005 Warner Ave	Lewiston ID 83501	Leo Millstein	208-743-0776/c-669-0170	leomillstein@mikes-mechanical.com		
	TK Elevator Corporation			Marcus Hardiman	425-305-1936	courtney.skinner@tkelevator.com		
	K&G Construction	625 D Street	Lewiston ID 83501	Chris Kilcup	208-553-4404	ckilcup@kandgconstructionllc.com		G.C.
	Schindler			Damon Rush	208-577-5535 / 208-941-0751	damon.rush@schindler.com		
	Ginno Construction	3893 N Schriber Way	Coeur d'Alene ID 83815	Dave Renaldo	208-691-5232	dave@ginnoconstruction.com		G.C.
	Gettis Contracting			Matthew Gettis	208-651-7675	kgettis@hotmail.com		G.C.
	IRS Environmental			Mike Blankenship	509-998-2595	mblankenship@rsenviro.com		
	Mike's Mechanical			Tyrel Funke	208-877-1654	tyrel@mikes-mechanical.com		
	Gropp Electric			Jerry Hansen	509-336-3972	jhansen@moscow.com		
	Gropp Electric			Travis Schluneger	509-595-8114	groppestimator@gmail.com		
	Quality Contractors			Trent Shaw	208-875-9921	tshaw@quality-contractors.com		
	HHP			Richard Fichter	509-339-5461	richardfichter@gmail.com		
	Air-Ops			Chad Hinkley	208-791-7916	chad.hinkley@air-opshvac.com		
	Strom Electric Inc.			Josh Orr	208-596-8398	jorr@stromelectric.net		
	Budinger & Associates			Haley Elkin	509-535-8841	helkin@budingerinc.com		
	Abadan Plan Center	603 E 2nd Ave.	Spokane, WA 99202	Ron Saylor	(509) 747-2964	planroom@abadanplancenter.com	PDF	Plan Center
	AGC Idaho-Boise Plan Room	1649 W Shoreline Dr Ste 100	Boise, ID 83702	Amanda Lines	208-472-0453/F-343-2521	planroom@idahoagc.org	PDF	Plan Center
	ARC Document Solutions	2700 W. Idaho Street	Boise, ID 83702	Mike Mahan	208-342-4141	mike.mahan@e-arc.com	PDF	Plan Center
	Associated Builder & Contractors	1760 E. Trent Ave.	Spokane, WA 99202		509-534-0826	admin@abcipc.org	PDF	Plan Center
	The Blue Book	800 East Main St.	Jefferson Valley, NW 10535	Tarissa	845-208-8602	bidinfo@mail.thebluebook.com	PDF	Plan Center
	Blueprint Specialties	6205 Overland Rd	Boise ID, 83709	Shawn	208-337-0294/F-208-323-9176	mail@bpsboise.com	PDF	Plan Center
	Builders Exchange of WA	2607 Wetmore Ave	Everett, WA 98201		425-258-1303/F-259-3828	production@bxwa.com	PDF	Plan Center
	Butte Builders Exchange	4801 Hope Road	Butte, MT 59701		406-782-5433/F-782-5433	butteplans@gmail.com	PDF	Plan Center
	Plan Center Northwest	PO Box 2486	Clackamas, OR 97015	Brie Kidwell	503-650-0148	brie@plancenternw.com	PDF	Plan Center
	Contractor Plan Center, Inc.	5468 SE International Way	Milwaukie, OR 97222	Svea Erickson	503-650-0148	svea@contractorplancenter.com	PDF	Plan Center
	Construct Connect	3825 Edwards Rd., Suite 800	Cincinnati, OH 45209	Stacey Mighton	800-364-2059/F866-570-8187	Content@constructconnect.com	PDF	Plan Center
	Construct Connect	3825 Edwards Rd., Suite 800	Cincinnati, OH 45209	Henri Bradshaw	800-364-2059/F866-570-8187	henri.bradshaw@constructconnect.com	PDF	Plan Center
	Construct Connect			James Baah	513-458-5813	James.Baah@Constructconnect.com	PDF	Plan Center
	Daily Journal of Commerce of Oregon	921 S.W. Washington St. Suite 210	Portland, OR 97205	Plan Room	503-274-0624	plancenter@djcoregon.com	PDF	Plan Center
	Deltek, Inc.	2291 Wood Oak Drive	Herndon VA 20171	Jacqueline Sessa		PublicRecords@deltek.com	PDF	Plan Center
	Dodge Data & Analytics			Carol Reichel		carol.reichel@construction.com	PDF	Plan Center
	Dodge Data & Analytics			April Hamilton	413-304-2008	april.hamilton@construction.com	PDF	Plan Center
	Dodge Data & Analytics			Adam Bouman		dodge.bidding@construction.com	PDF	Plan Center

REGISTER OF BID DOCUMENTS

PROJECT: 23255 UI: New Elevator / Access Improvements, Hartung Theater

CKA PROJECT NO: 22082

OWNER: State of Idaho Division of Public Works

REFUNDABLE DEPOSIT: \$200/EACH SET

INVITED LIST X OPEN PREQUALIFICATION

TODAY'S DATE: October 10, 2024

BIDS DUE DATE: **Tuesday, October 15th, 2024 @ 2:00 PM (local)** @ DPW Field Office – 875 Perimeter Drive, MS 2281Moscow, ID 83844

PRE-BID MEETING: **Tuesday, October 1st, 2024 @ 9:00 AM (local)** @ AES Facilities – 875 Perimeter Drive, MS 2281Moscow, ID 83844

ADDM	NAME	ADDRESS	CITY	ATTN:	PHONE/FAX	EMAIL	SET #	NOTES
	Dodge Data & Analytics			Rechie Manalop	844-326-3826 ext. 7134	Rechie.Manalop@construction.com	PDF	Plan Center
	Hermiston Plan Center	1565 N 1st St Ste 8a	Hermiston, OR 97838	Staci McQuain	(541) 564-0420	office@hermistonplancenter.com	PDF	Plan Center
	Idaho Plan Room	4082 Chinden Blvd.	Boise, ID 83714		208-342-4141/F-208-343-5894	boise.print@e-arc.com	PDF	Plan Center
	Inland NW AGC	4935 E Trent Avenue	Spokane, WA 99212	Mary Tantriella	509-534-1446/F-535-2680	mtantriella@nwagc.org	PDF	Plan Center
	Lewiston-Clarkston Plan Service	2117 12th Avenue	Lewiston, ID 83501	Celia Weibler	(208) 746-3591/F (208) 746-5541	lcplancenter@gmail.com	PDF	Plan Center
	Missoula Plan Exchange	201 N Russell St	Missoula, MT 59801	Twyla Brooks	406-549-5002	mpe@vemcoinc.com	PDF	Plan Center
	Postal Copy Plus	601 3rd Street	Clarkson, WA 99403	Dave Irby	509-758-0234	postalcopy@gmail.com	PDF	Plan Center
	Premier Builders Exchange	1902 NE 4th St	Bend, OR 97701	Candice Gerhardt	(541) 389-0123	admin@plansonfile.com	PDF	Plan Center
	Seattle Daily Journal of Commerce	83 Columbia Street	Seattle, WA 98104	Ken Elliott	(206) 622-8272	plans@dj.com	PDF	Plan Center
	Seattle Daily Journal of Commerce			Chrisy Martin	206-622-8272	chrisy.martin@dj.com	PDF	Plan Center
	Seattle Daily Journal of Commerce			Alexandra Lavorato	206-622-8272	alex.lavorato@dj.com	PDF	Plan Center
	Spokane Regional Plan Center	209 N Havanja St	Spokane, WA 99220	Jenny Martin	509-328-9600/F-7279	projectinfo@plancenter.net	PDF	Plan Center
	Tri Cities Construction council	20E Kennewick Ave	Kennewick, WA 99336	Christina Camp	509-582-7424/F509-582-6815	christina@tcplancenter.com	PDF	Plan Center
	Tri Cities Construction council	20E Kennewick Ave	Kennewick, WA 99336	Kailey Casey	509-582-7424/F509-582-6815	bidinfo@tcplancenter.com	PDF	Plan Center
	Walla Walla Valley Plan Center	29 E Sumach St	Walla Walla, WA 99362	Kyle Tarbet	(509) 525-0850	ktarbet@wwchamber.com	PDF	Plan Center
	Yakima Plan Center	1909 W Lincoln Ave #2	Yakima, WA 98902	Jacki Bernardino	(509) 457-4271	jacki@yakimaplancenter.com	PDF	Plan Center
	Sika Sarnafil	2881 South 900 West	Salt Lake City, UT 84105	Ryan Sackville	(801) 633-3045	ryan@pivotbep.com	PDF	
	GAF			Mike Chrismer	208-761-2596	mike.chrismer@gaf.com	PDF	
	Carlisle			Gary Horner		gary@homerassocd7.com	PDF	
	Versico			Justin Spencer		js_division7specialties@msn.com	PDF	
	Garland			Drew Wright		dwright@garlandind.com	PDF	
	Metal Sales			Lee Mosbrucker		lmosbrucker@metalsales.us.com	PDF	
	MBCI			Steve Russell		steven.russell@mbci.com	PDF	
	C&C Construction of the Pacific NW							

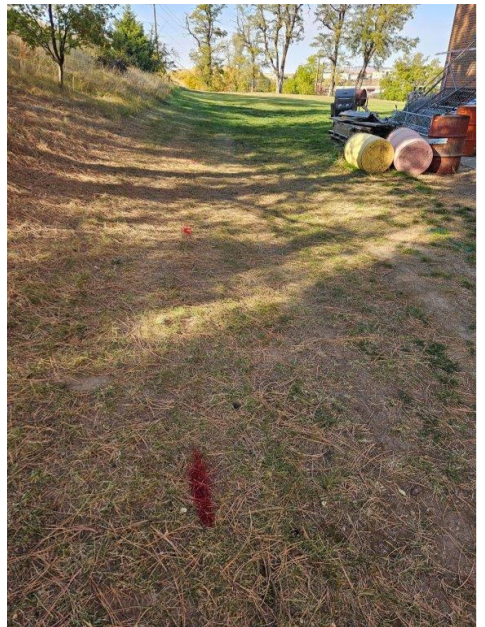
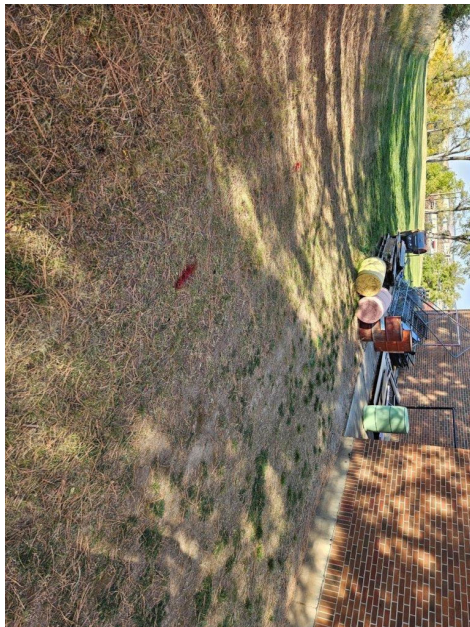
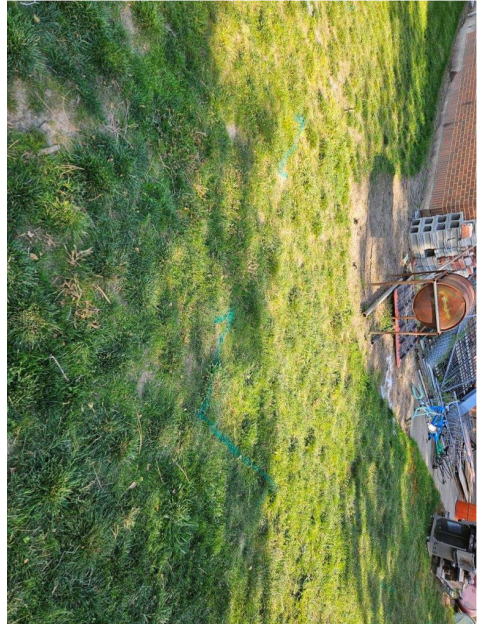



SECTION 10 19 10 – PRIVACY CURTAINS

PART 1 - GENERAL

1.01 SUMMARY

- A. This section includes the following:
 - 1. Privacy curtain and track.

1.02 SUBMITTALS

- A. Product Data: Manufacturer's printed product data for each type of privacy curtain and track specified.
- B. Fabric Samples: Swatch cards of fabric samples weave.

1.03 WARRANTY

- A. Standard Limited Warranty against material and manufacturing defects.

1.04 MAINTENANCE MATERIALS

- A. Extra Materials: Provide 1 extra curtain to be turned over to owner.

PART 2 - PRODUCTS

2.01 MANUFACTURER

- A. Basis of Design: InPro Corporation, PO Box 406 Muskego, WI 53150 USA; Telephone: 800-222-5556, Fax: 888-715-8407, Internet address: <http://www.inprocorp.com> .
- B. Substitutions: Equivalent products by other manufacturers will be allowed.

A.02 MATERIALS

- A. Privacy Curtain: Shield by Panaz Antimicrobial Fabric Privacy Curtain
 - 1. Provide non woven, 100% polyester fabric, modified with nano-molecular, anti-bacterial and water repellent technologies. Fabric shall be anti-bacterial and stain resistant.
 - 2. Open Mesh Cloth: Provide curtain heading of open weave nylon mesh material with #50 1/2" holes to permit air circulation. Mesh is to be flame retardant, washable and dry-cleanable.
- B. Track:
 - 1. CES Track Series CE5038 - with ball and chain carriers.
 - 2. Suspend from 8'-6" tall ceiling so track runs under existing lights.
- C. Amount:
 - 1. Provide a total of 3 curtains. Install 2 curtain and provide additional curtain to owner as maintenance stock.

2.03 FINISH AND COLOR

- A. Shield Designer Fabric.
 - 1. Select solid or patterned fabric from manufacturer's standard selection. Fabric shall have a satin luster and printed on both sides.
- B. EZE•Mesh Top
 - 1. Select mesh material in a color from manufacturer's standard selection.

2.04 FABRICATION

- A. Privacy Curtain
 - 1. Curtain Width: Manufacture curtains of one piece, sized to 10 percent wider than the track length but no less than 1'-0" extra fullness;
 - 2. Curtain Height: 7'-0". Bottom of privacy curtain hangs 1/2" above floor;
 - 3. Curtain Heading: Manufacture with heading of open mesh cloth, to the same width as the curtain fabric. Include 4-ounce nickel-plated grommets, 6" on center for carriers. Top hem to be triple-turned hem over nylon tape for rugged wear.
 - 4. Seams: Curtains shall be seamless with sanitary "no scum" side and bottom edges. Sewing thread to be triple-ply twisted nylon.

PART 3 - EXECUTION

3.01 EXAMINATION

- A. Examine areas and conditions in which the curtain tracking systems will be installed.
 - 1. Complete all finishing operations, including painting, before beginning installation of cubicle tracking system materials.
 - 2. Verify that surfaces and above ceiling supports/blocking are ready to receive work.

3.02 PREPARATION

- A. General: Prior to installation, clean substrate to remove dust, debris and loose particles.

3.03 INSTALLATION

- A. Install the curtain track in accordance with the manufacturer's instructions.

3.04 CLEANING

- A. At completion of the installation, remove any debris and clean surfaces in accordance with the track clean-up and maintenance instructions.

END OF SECTION 10 19 10